

LCC Modelling System

B 00-16 Bundle: Laneside warehouse

Bundle contains:

- 1x LCC 00-02
- 1x LCC 00-09
- 1x LCC 00-13
- 2x LCC 00-21
- 1x LCC 00-22
- 2x LCC 00-23
- 2x LCC 00-24A
- 2x LCC 00-24B
- 1x LCC 00-41
- 4x LCC 04-08
- 4x LCC 04-09
- 8x LCC 04-11
- 4x LCC 04-12
- 4x LCC 04-21
- 1x LCC 04-26
- 1x LCC 04-40
- 1x LCC 04-41
- 1x LCC 04-42
- 1x LCC 04-43
- 2x LCC 04-44
- 1x LCC 04-45
- 1x LCC 04-46
- 3x LCC 04-50
- 1x LCC 04-51
- 6x LCC 04-61
- 6x LCC 04-62
- 6x LCC 04-63
- 6x LCC 04-64
- 1x LCC 04-65
- 1x LCC 04-66
- 7x LCC 04-68
- 1x LCC 04-69
- 10x LCC 04-70
- 1x LCC 04-71
- 1x LCC 04-72
- 1x LCC 04-73
- 1x LCC 04-74
- 1x LCC 04-75
- 1x LCC 04-76

This kit contains elements which can be used to build a two stories lineside warehouse.

Footprint:

Length: 237mm (with office)

Length: 188mm (without office)

Width: 123mm

For more instruction go to manual which you can download form our website www.lcut.co.uk

All drawings are not in scale.

LCC Modelling System is flexible and you can make easy modification. Please visit our website at www.lcut.co.uk to shop for additional LCC elements.

! We recommend PVA or any other paper/wood glue.

OFFICE WITH BASEMENT

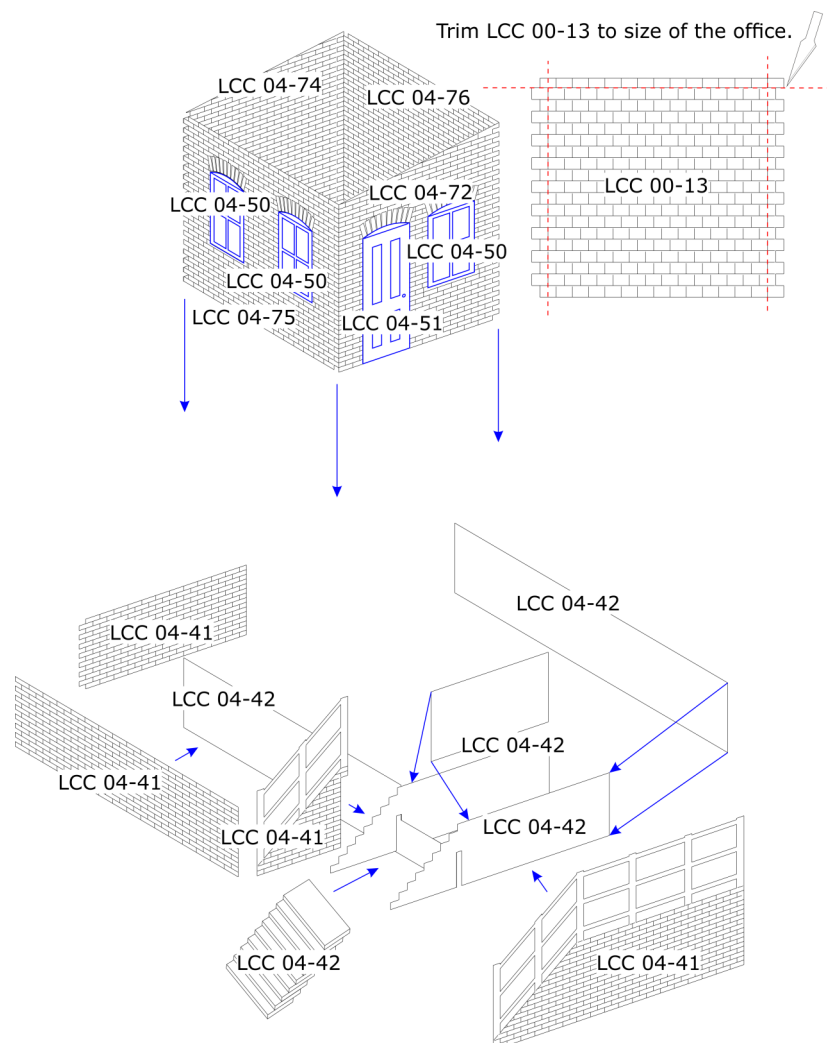

FRONT ELEVATION

Trim LCC 04-09 to fit between decoration strips

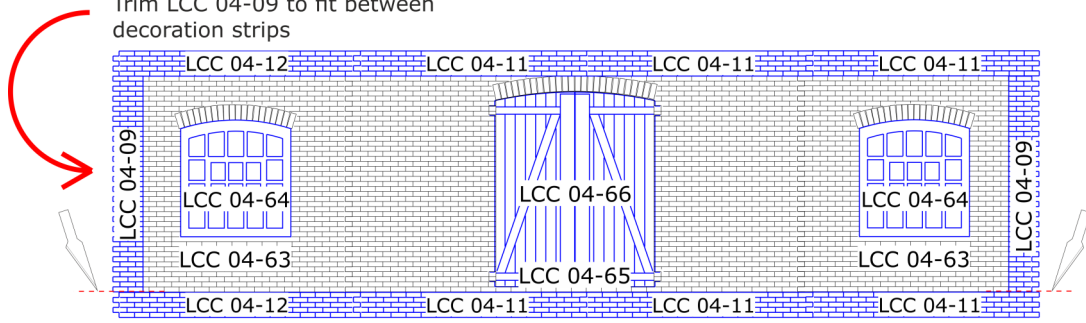

Glue bottom decoration strips LCC 04-12 and LCC 04-11 three bricks lower than the bottom edge of LCC 04-63 and LCC 04-65. Use decoration strips to hide the connection line between elevations.

Trim LCC 04-08 to fit between decoration strips

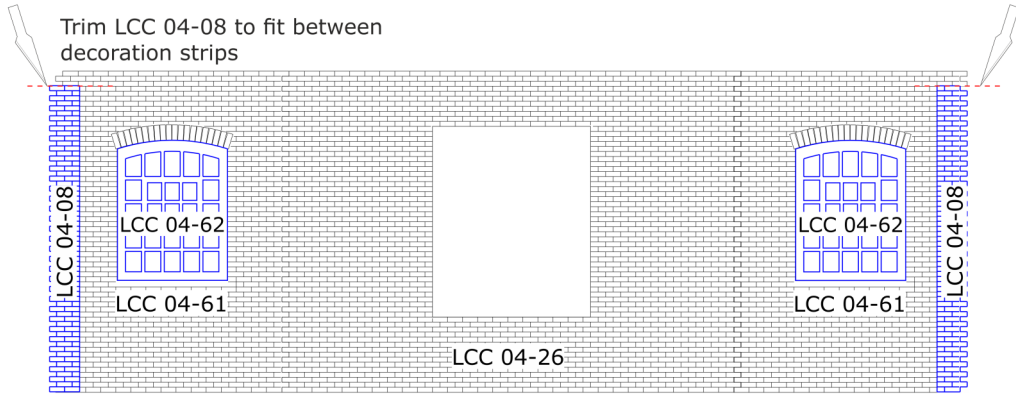

Fold strips inwards in along the line.

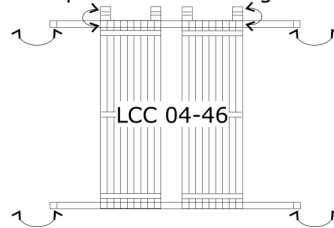

FLOORS

Arrange LCC 04-68 and LCC 04-69 to create floor. Join the pieces with LCC 04-70 on the seams. Glue additional LCC 04-70 on the shorter sides if desired. One LCC 04-70 parallel to the longer side of the floor will require trimming to fit between other LCC 04-70.

! Use LCC 04-68 instead of LCC 04-69 for the second storey.

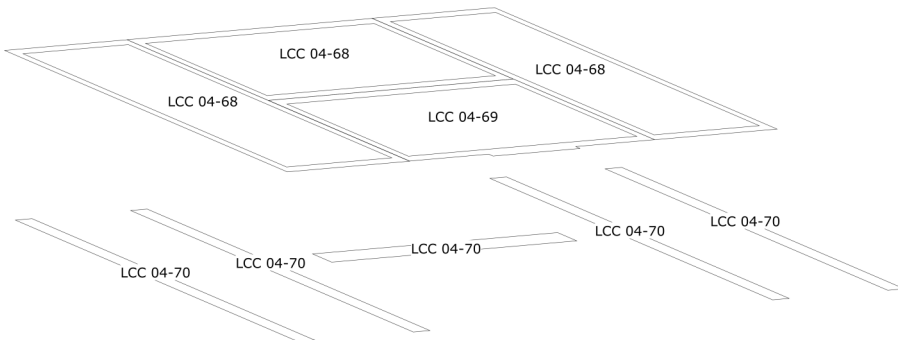

Glue floors on the same level as the gates of both floors. Use the notch in LCC 04-69 to locate bottom floor on the correct level. Second storey floor can be glued flush with the window panels (not decorations panels)

SIDE ELEVATIONS

Trim LCC 04-21 to height of LCC 04-63 to fit the second floor.

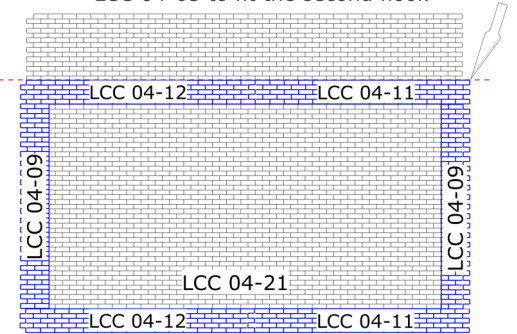

Trim LCC 04-08 to fit between decoration strips

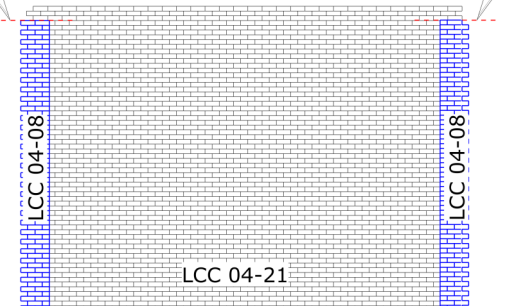

BACK ELEVATION

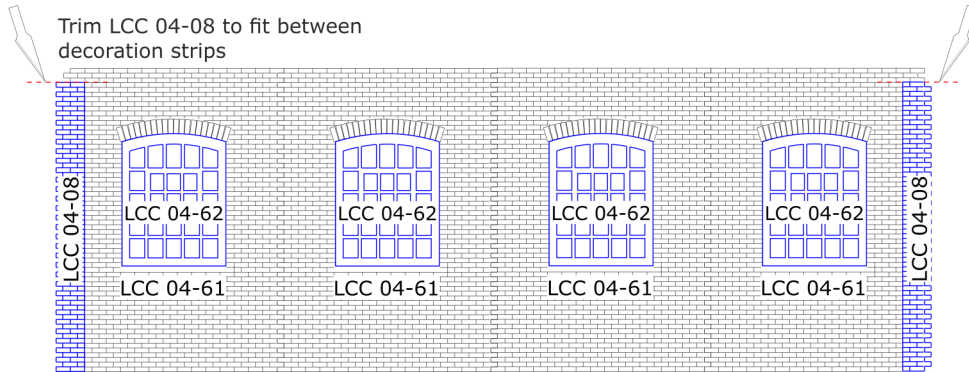
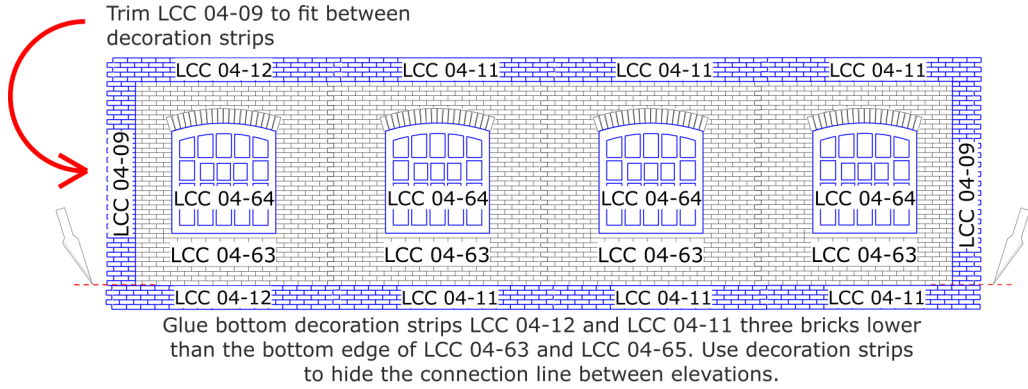

LOADING PLATFORM

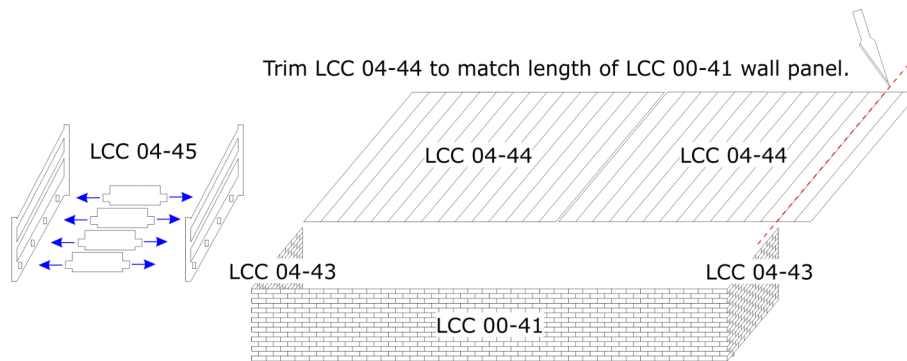

ROOF

